

ALICLAD

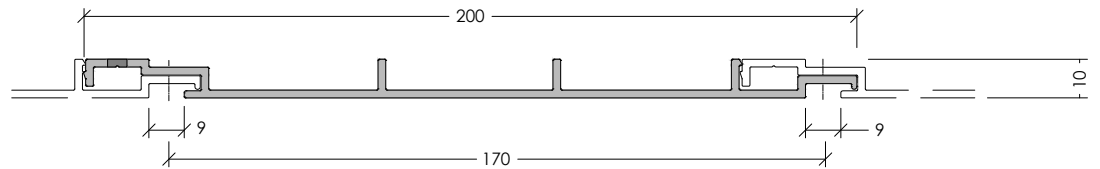



S170

Square Groove Wall & Soffit Lining -

- 170mm Coverage
- 7.8kg/m²

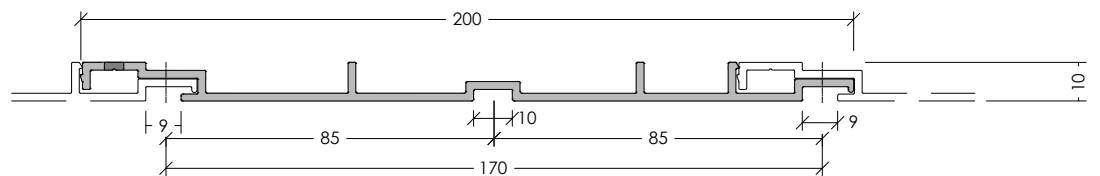

S085

Square Groove Wall & Soffit Lining -

- 170mm Coverage
- 8kg/m²

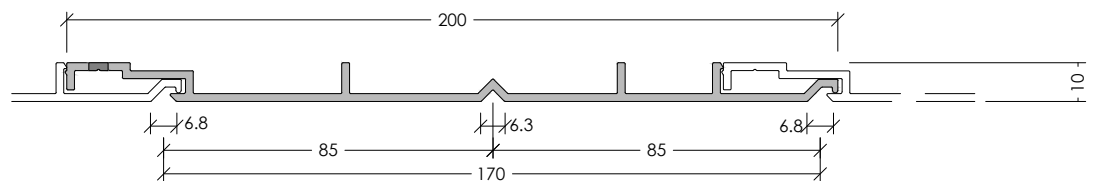

V085

Vee Groove Wall & Soffit Lining -

- 170mm Effective Coverage
- 7.8kg/m²

ALICLAD

JMDB

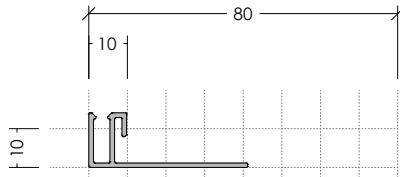

Trim Base, 3.6m, Selected Finish.

HMDB

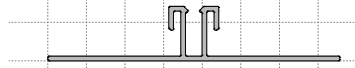

Jointer Base, 3.6m.

SJMDB



Shadow Base, 3.6m, Selected Finish.

HMDF

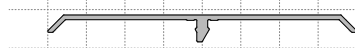

80mm Jointer Face - 10mm, 3.6m, Selected Finish.

JMDF

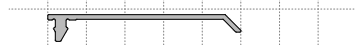

50mm Trim Face - 10mm, 3.6m, Selected Finish.

ORDER SHEET:	_____
CUSTOMER NAME:	_____
PO#:	_____
COLOUR:	_____

ACCESORIES

Detail Number _____

ACC-01

Scale _____ Version _____

A4 1:2 [2.0] - Aug 2024



MATERIALS • SYSTEMS • SOLUTIONS

JMB

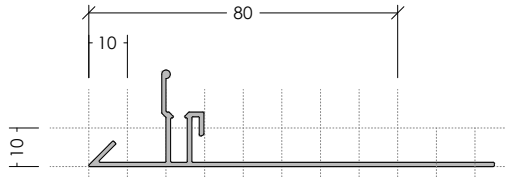

Jamb Base, 3.6m,
Selected Finish.

BOC



Bottom of Cladding Base, 3.6m,
Punched, Selected Finish.

INTB

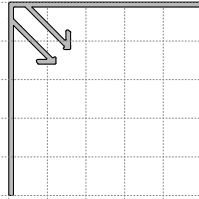

Internal Corner Base, 3.6m,
Selected Finish.

INTF

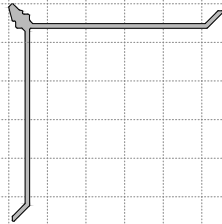

Internal Corner Face, 3.6m,
Selected Finish.

EXTB

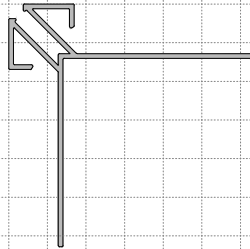

External Corner Base, 3.6m,
Selected Finish.

EXTF

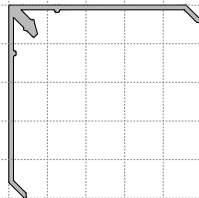

External Corner Face, 3.6m,
Selected Finish.

ACCESORIES

Detail Number _____

ACC-02

Scale _____ Version _____

A4 1:2 [1.0] - May 2024

ALICLAD



Trim Base



50 mm Trim Face - 10mm

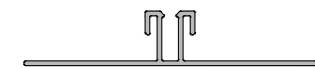
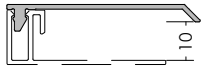

Jointer Base



80mm Jointer Face - 10mm

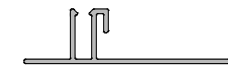
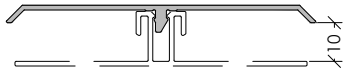

Shadow Base



50 mm Trim Face - 10mm

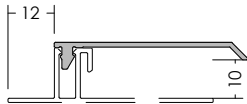

Jamb Base



50 mm Trim Face - 10mm



COMMON CLADDING ACCESSORY PAIRINGS

Detail Number

 ACC-03

Scale Version

 A4 1:2 [2.0] - Aug 2024



MATERIALS • SYSTEMS • SOLUTIONS

ALICLAD



Bottom of Cladding Base

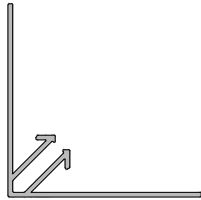
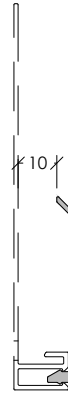

Internal Corner Base

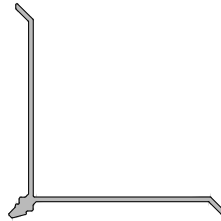

Internal Corner Face

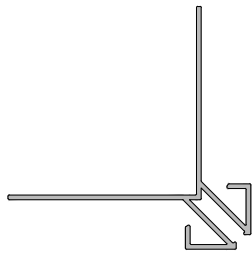
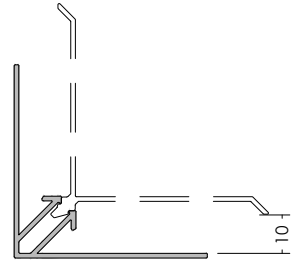

External Corner Base

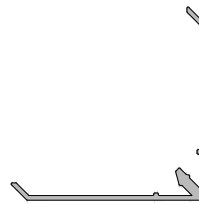

External Corner Face

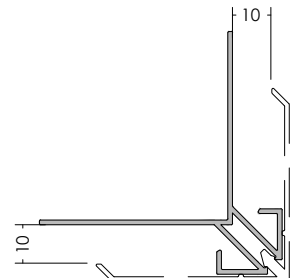

COMMON CLADDING ACCESSORY PAIRINGS

Detail Number
_____ ACC-04
Scale _____ Version _____
A4 1:2 [1.0] - May 2024



MATERIALS • SYSTEMS • SOLUTIONS

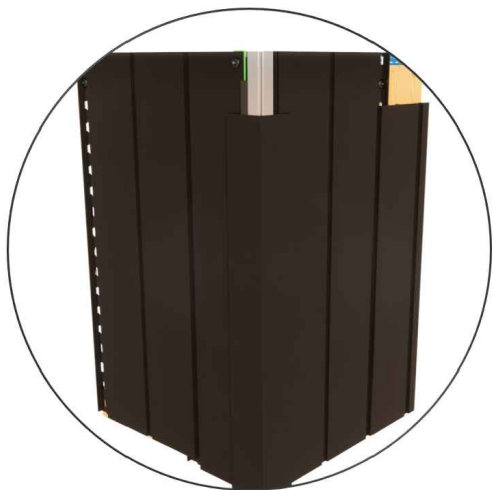
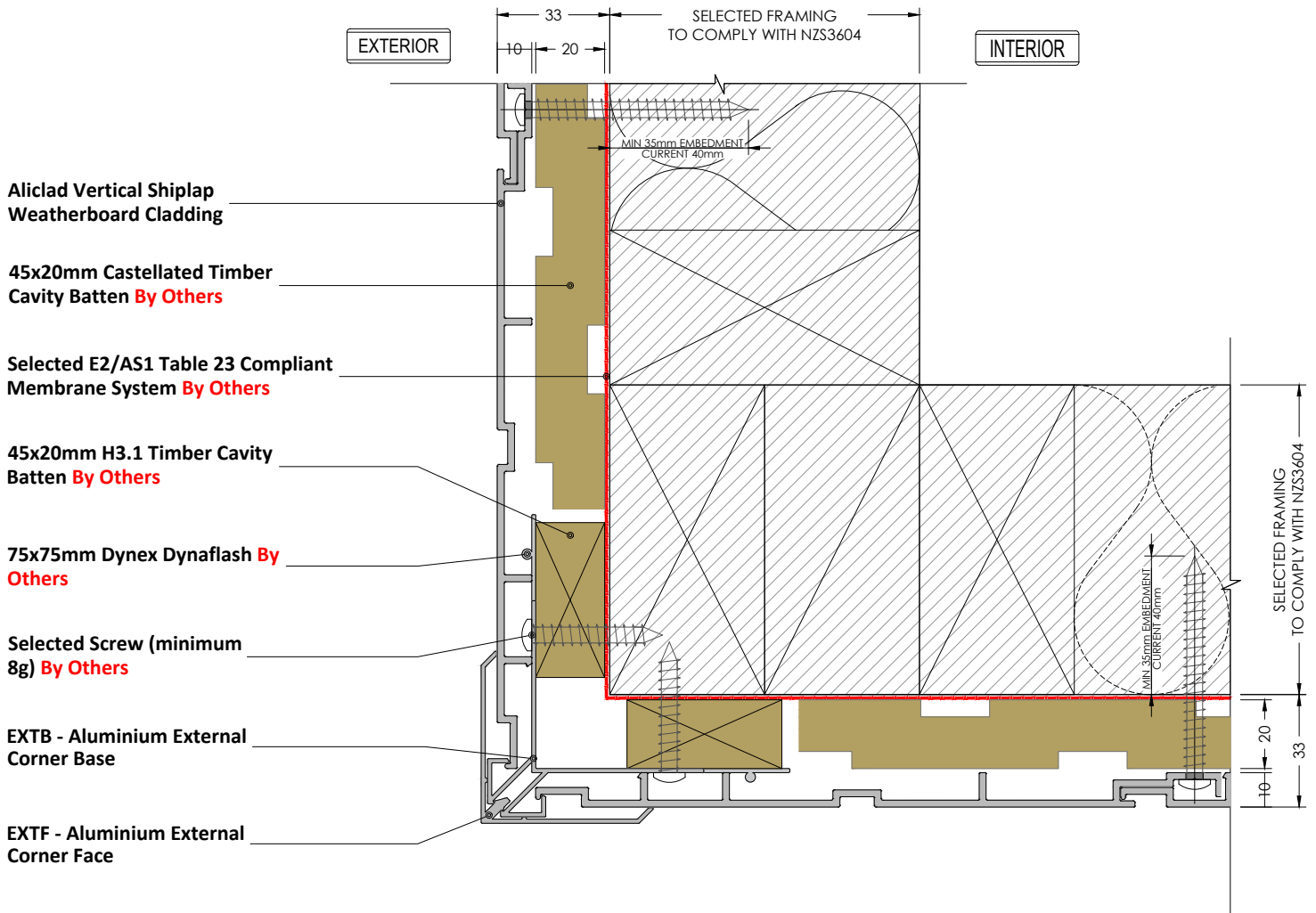

Alternative When Board is Cut

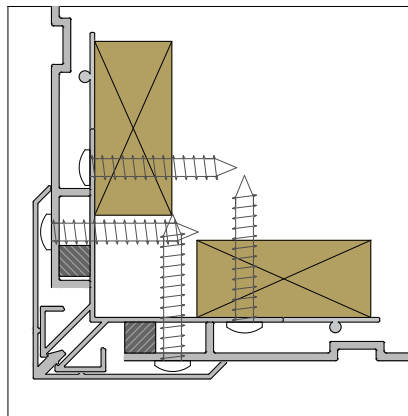

Refer to Test Report
SWTL R0067



EXTERNAL CORNER

Detail Number	
Scale	Version
A4 1:2	[2.0] - Aug 2024

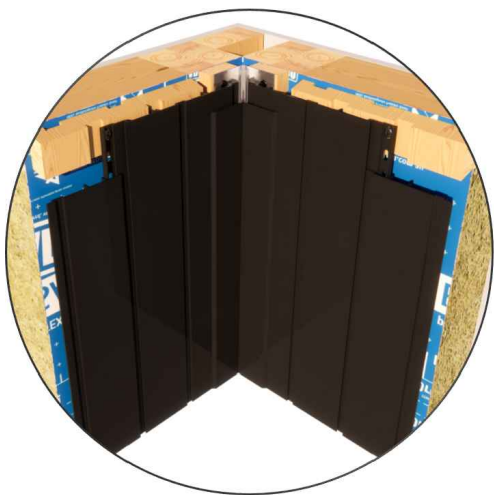
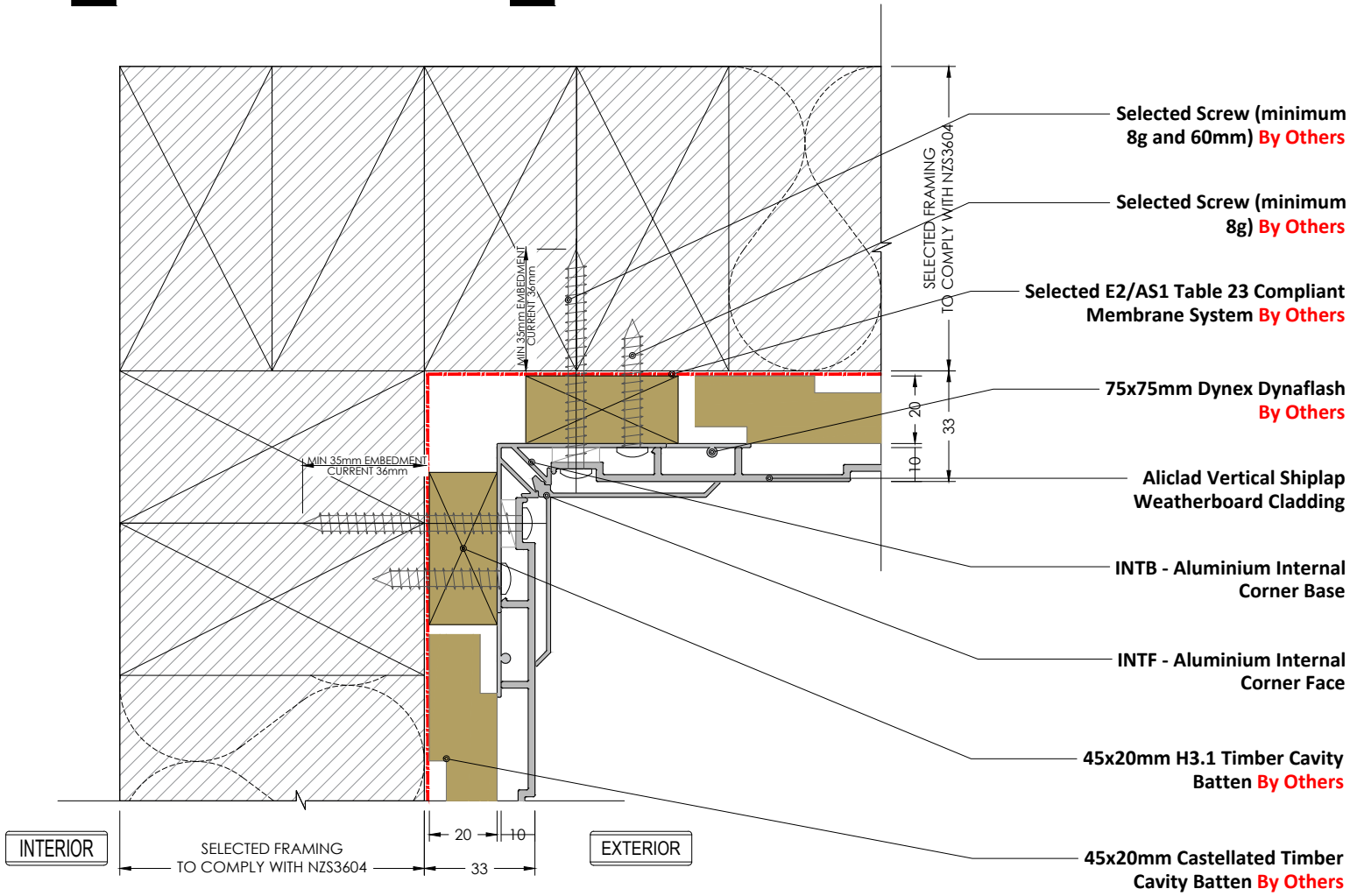

Alternative When Board is Cut

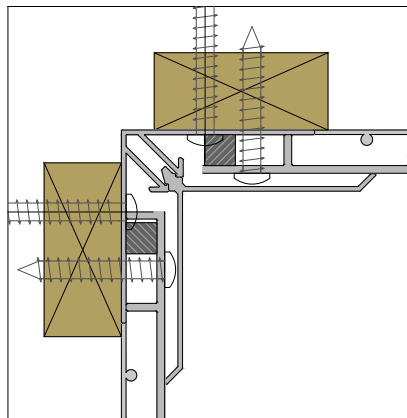

Refer to Test Report
SWTL R0067



INTERNAL CORNER

Detail Number _____
 Scale _____ Version 2.0
 A4 1:2 [2.0] - Aug 2024



MATERIALS • SYSTEMS • SOLUTIONS

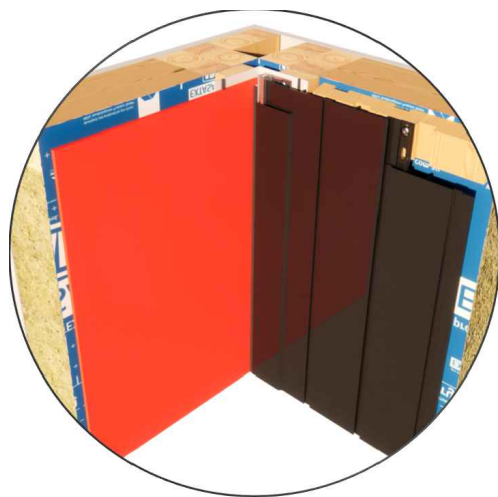
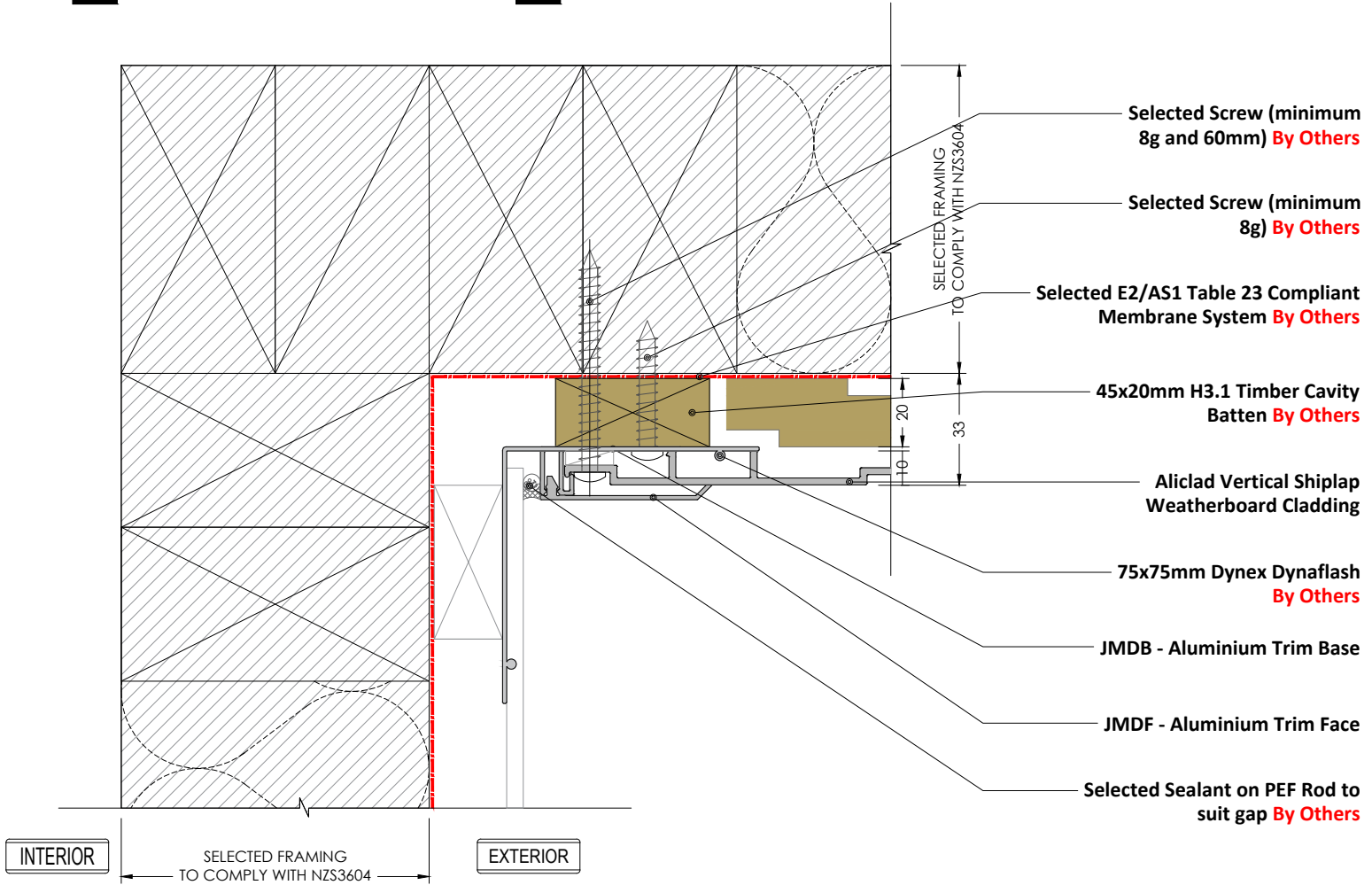

Alternative When Board is Cut

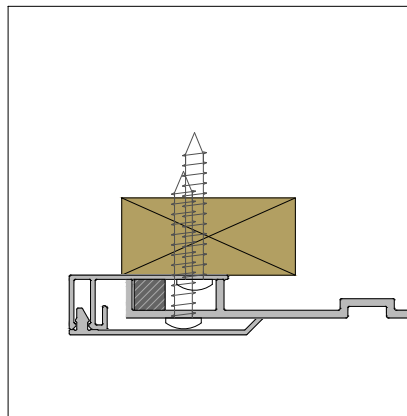

INTERNAL CORNER AT ALTERNATE CLADDING

Detail Number	
Scale	Version
A4 1:2	[2.0] - Aug 2024

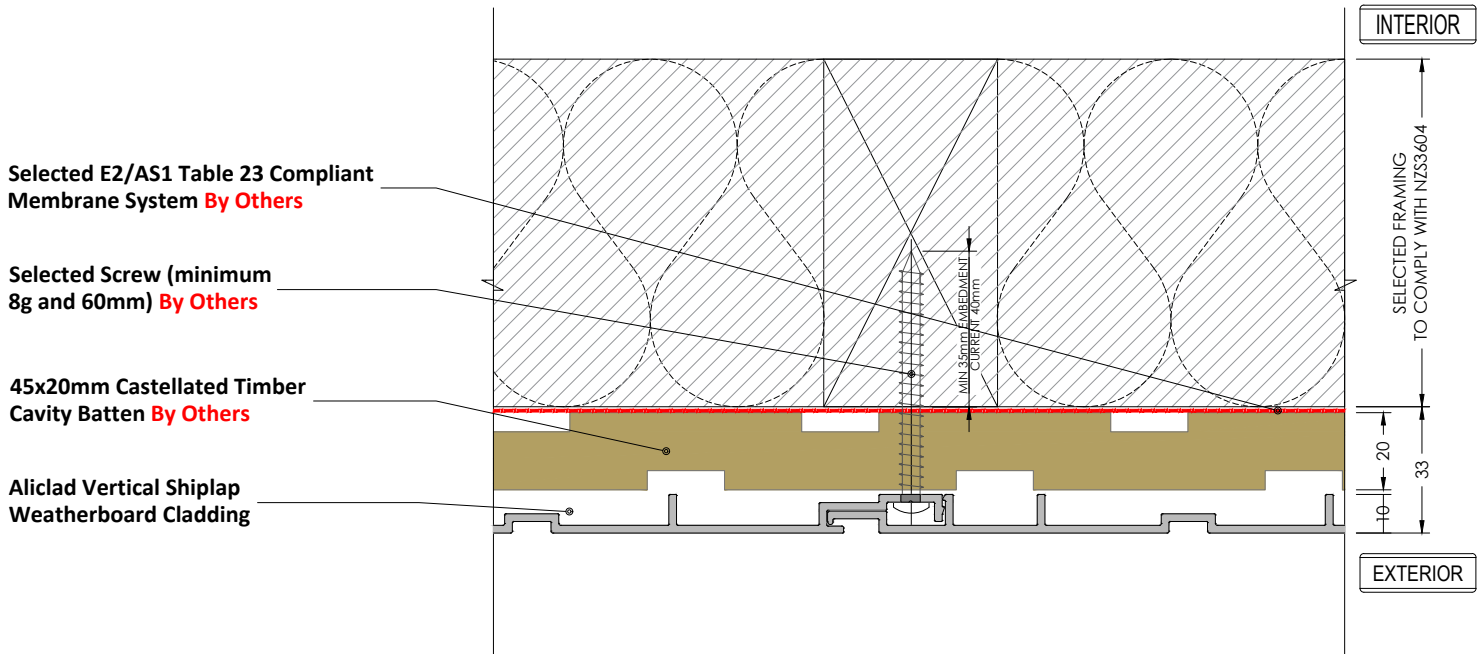

Refer to Test Report
SWTL R0067



TYPICAL VERTICAL JOINT

Detail Number _____

Scale _____ Version 3.0

A4 1:2 [2.0] - Aug 2024

Selected E2/AS1 Table 23 Compliant
Membrane System **By Others**

Selected Screw (minimum
8g) **By Others**

45x20mm H3.1 Timber Cavity
Batten **By Others**

HMDB - Aluminium Joints Base

75x75mm Dynex Dynaflex
By Others

HMDF - Aluminium Joints Face

Aliclad Vertical Shiplap
Weatherboard Cladding

Aliclad Vertical Shiplap
Weatherboard Cladding

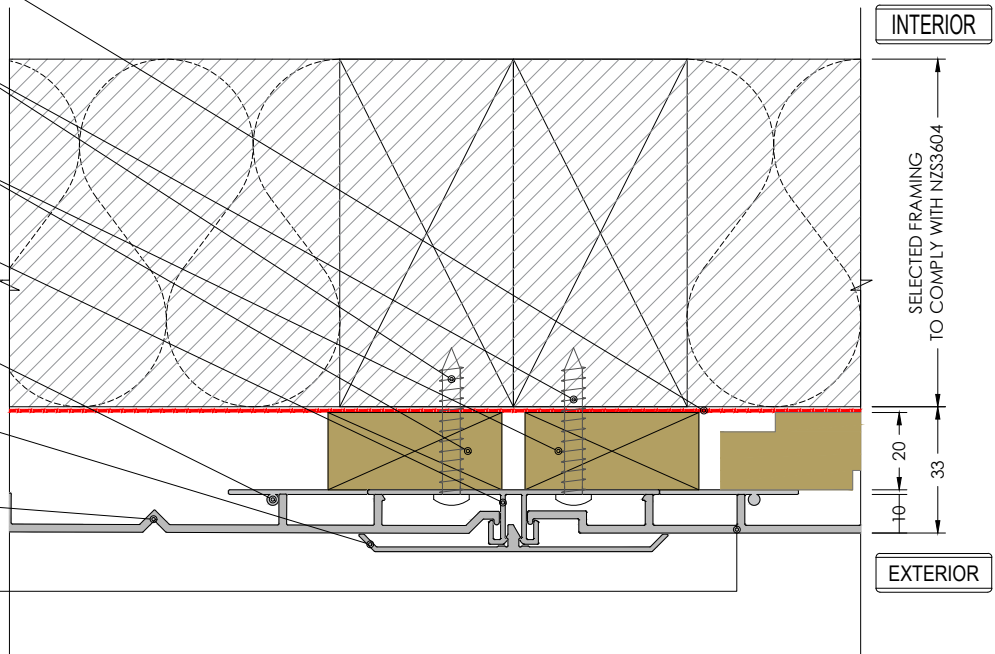

Refer to Test Report
SWTL R0067



VERTICAL JOINT CHANGE OF BOARD

Detail Number _____
Scale _____ Version 3.1
A4 1:2 [2.0] - Aug 2024

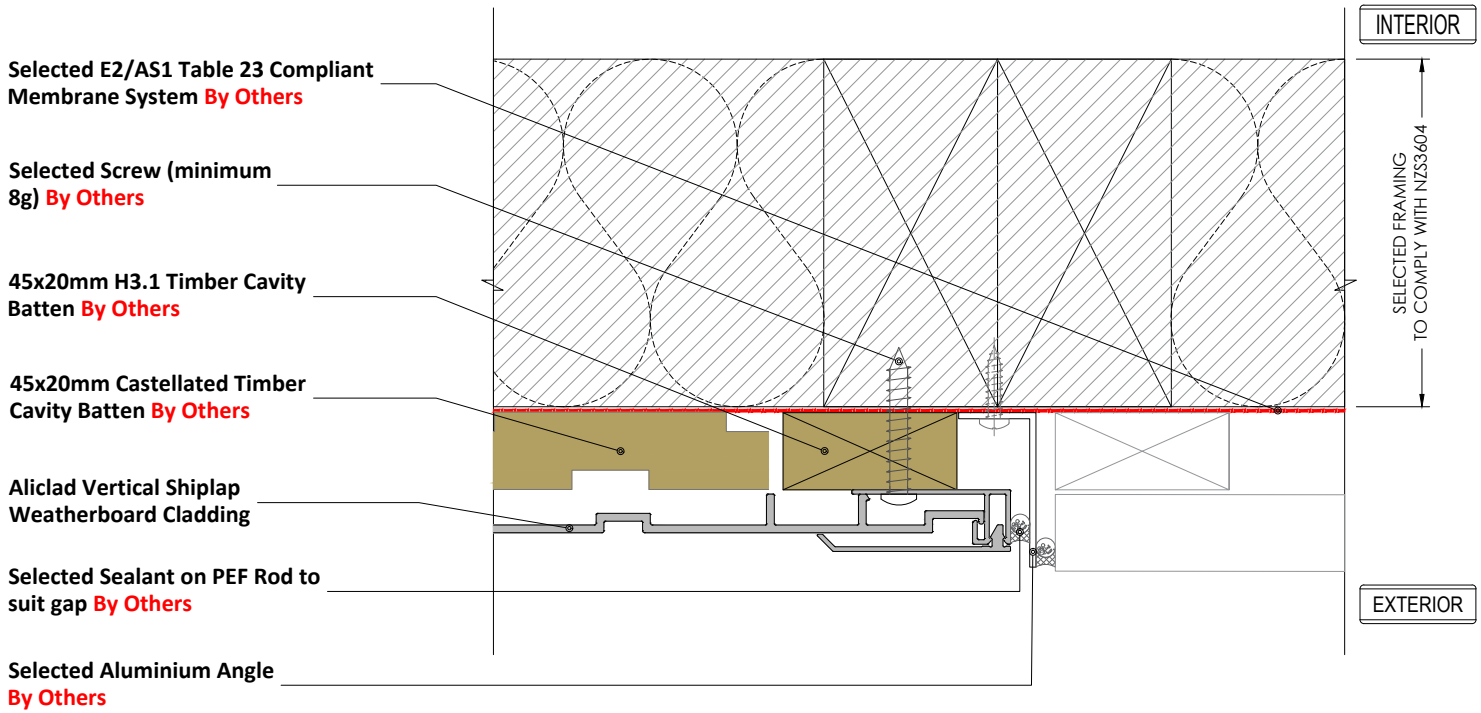

Alternative When Board is Cut

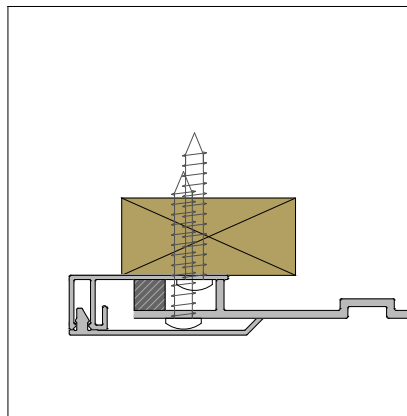

VERTICAL JOINT AT ALTERNATE CLADDING

Detail Number _____

Scale _____ Version 3.2

A4 1:2 [2.0] - Aug 2024

Aliclad Vertical Shiplap
Weatherboard Cladding

Selected E2/AS1 Table 23 Compliant
Membrane System **By Others**

Selected Screw (minimum
8g and 60mm) **By Others**

Selected Flashing Tape Over Flashing
By Others

45x20mm Castellated Timber
Cavity Batten **By Others**

BOC - Aluminium Bottom of Cladding Base

Selected Cavity Closure **By Others**

JMDF - Aluminium Trim Face

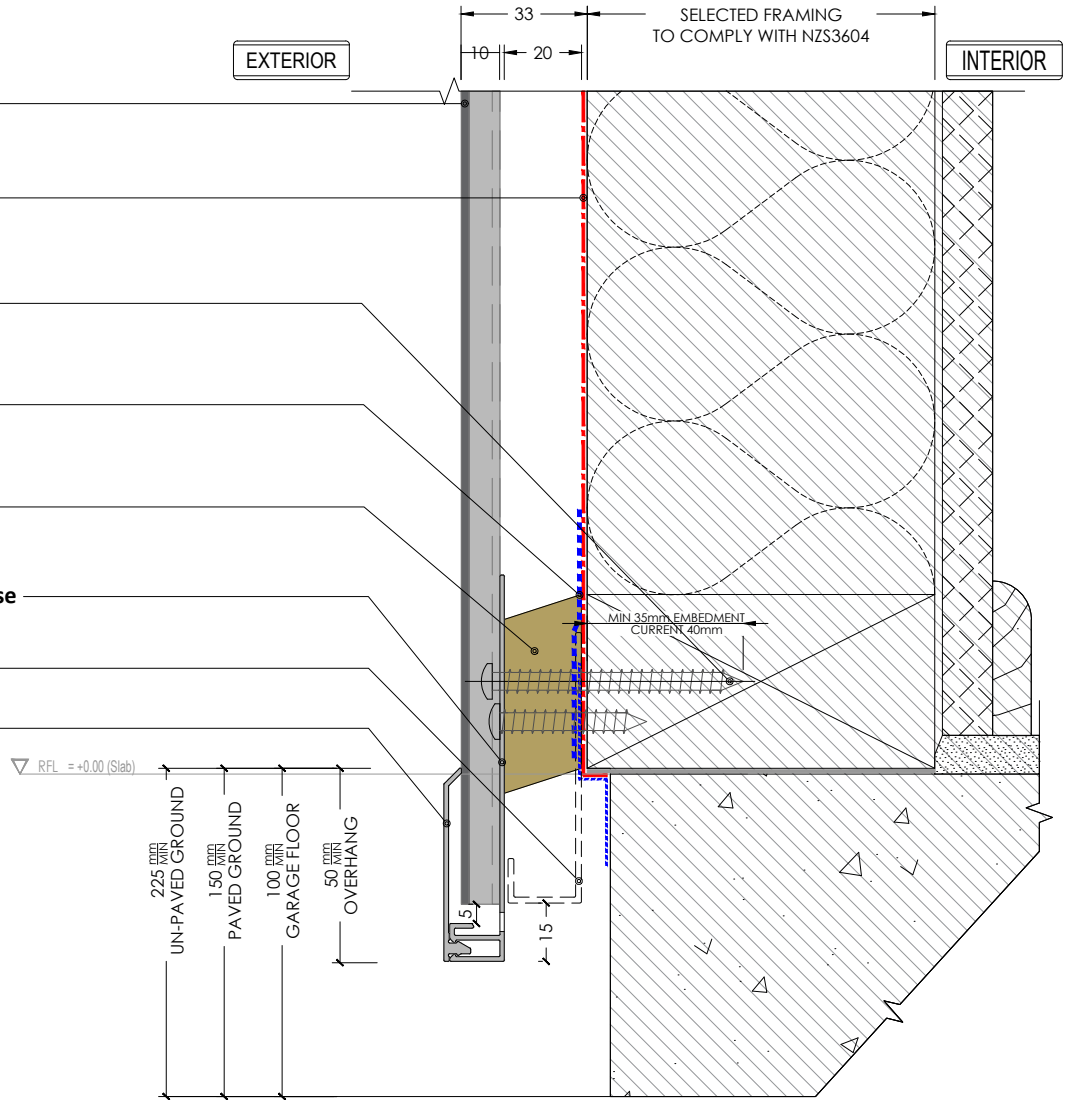

Refer to Test Report
SWTL R0067



TYPICAL CLADDING BASE AT FLOOR SLAB

Detail Number _____
Scale _____ Version 5.0
A4 1:2 [2.0] - Aug 2024

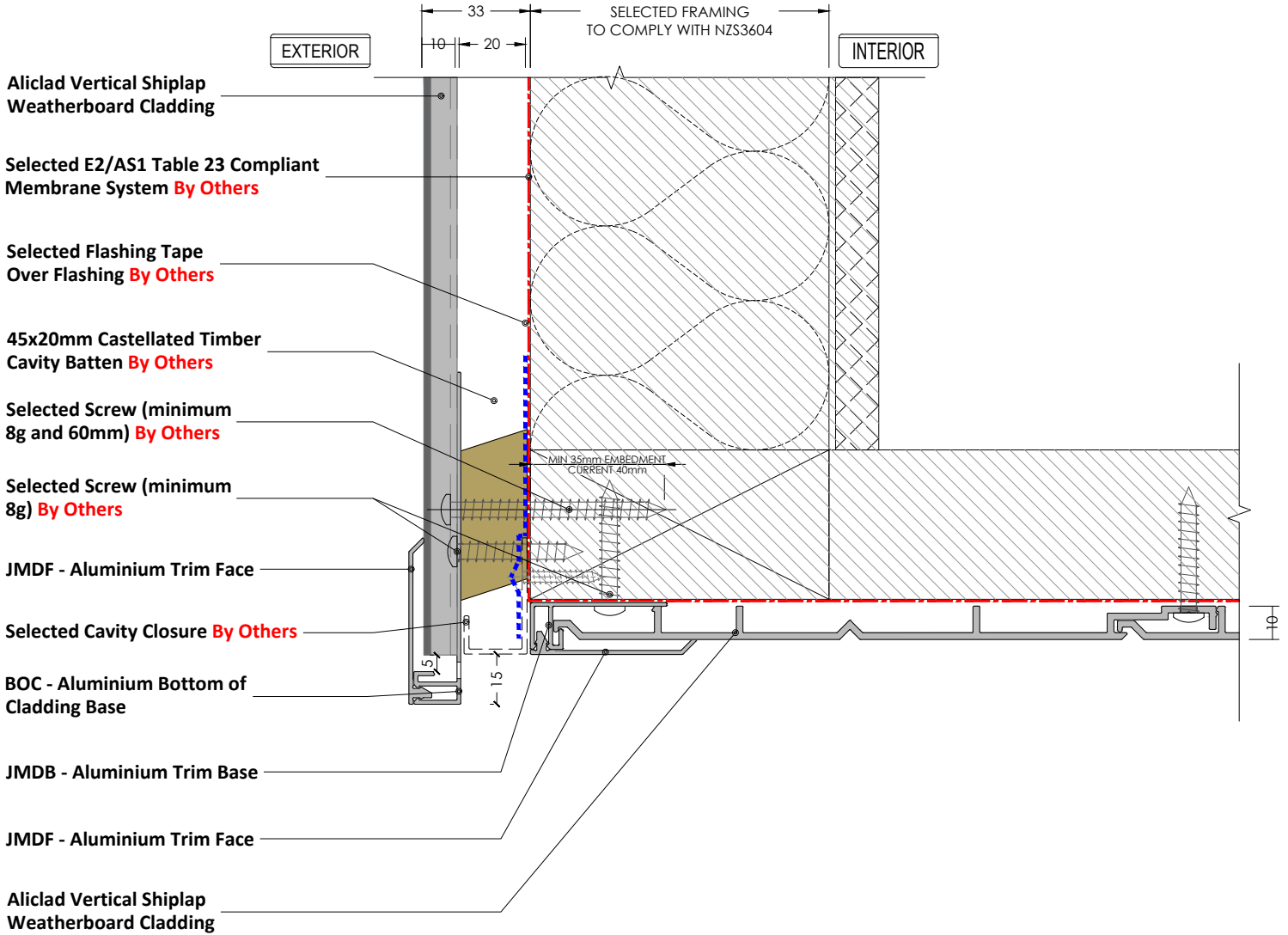

Refer to Test Report
SWTL R0067



TYPICAL CLADDING WALL TO SOFFIT

Detail Number _____
Scale _____ Version 5.2
A4 1:2 [2.0] - Aug 2024

Selected Flashing Tape AT Corner lap
Behind Fascia **By Others**

JMDB - Aluminium Trim Base

Selected Screw (minimum
8g) **By Others**

Selected Screw (minimum
8g and 60mm) **By Others**

45x20mm Castellated Timber
Cavity Batten **By Others**

JMDF - Aluminium Trim Face

Selected E2/AS1 Table 23 Compliant
Membrane System **By Others**

Aliclad Vertical Shiplap
Weatherboard Cladding

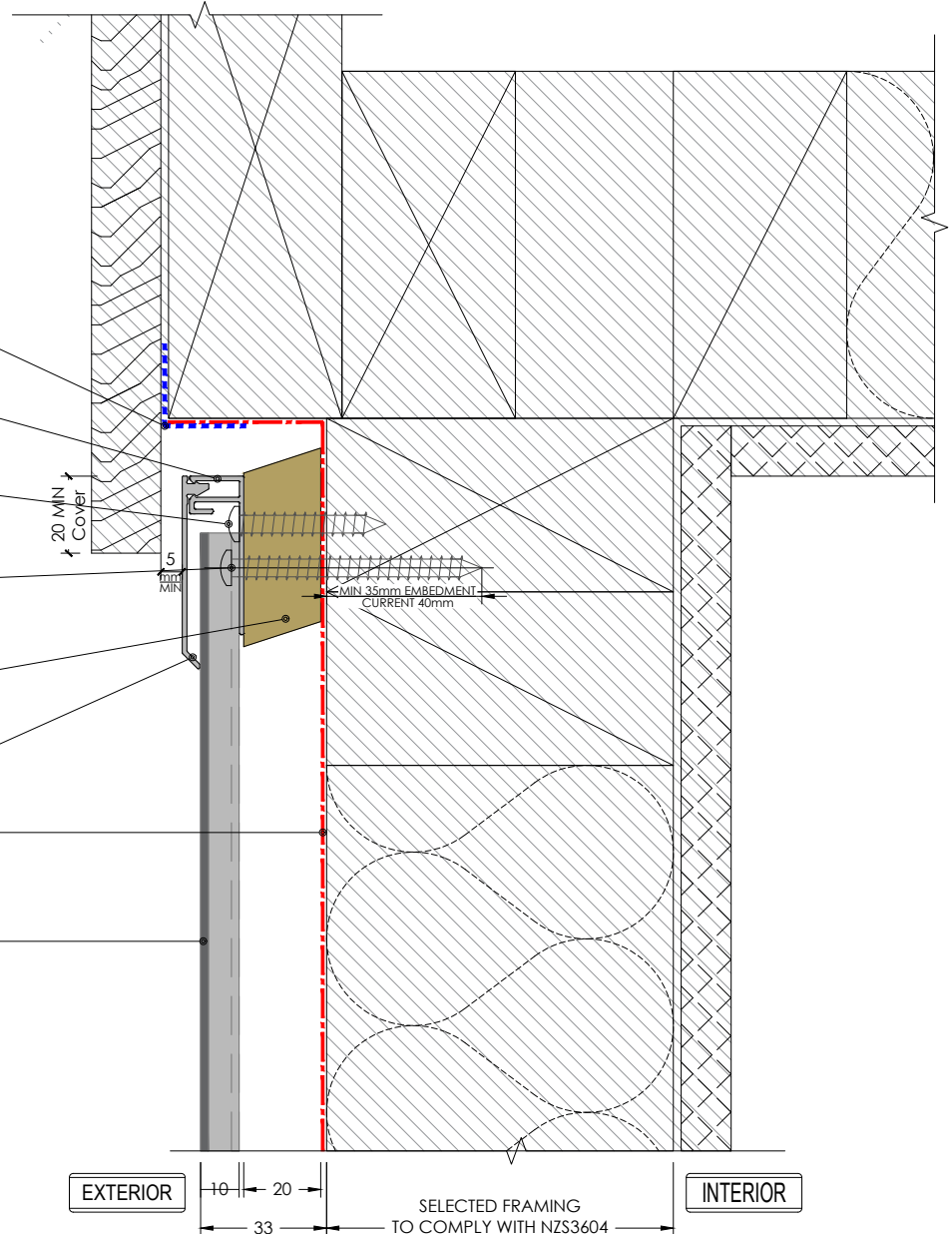

TYPICAL CLADDING TOP AT FASCIA

Detail Number

6.0

Scale Version

A4 1:2 [2.0] - Aug 2024

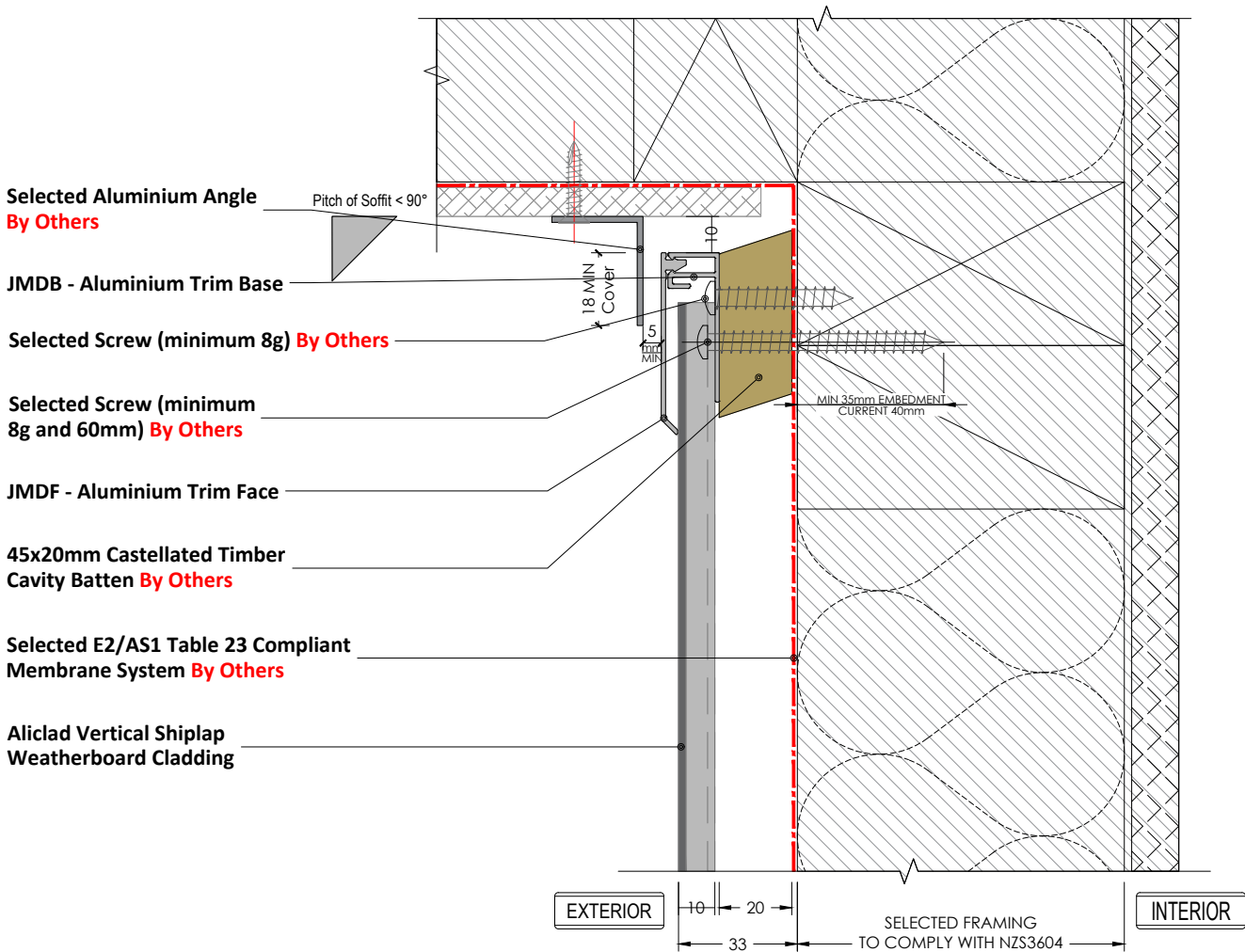

SOFFIT / EAVE TO WALL

Detail Number
_____ 6.1

Scale _____ Version _____

A4 1:2 [2.0] - Aug 2024



MATERIALS • SYSTEMS • SOLUTIONS

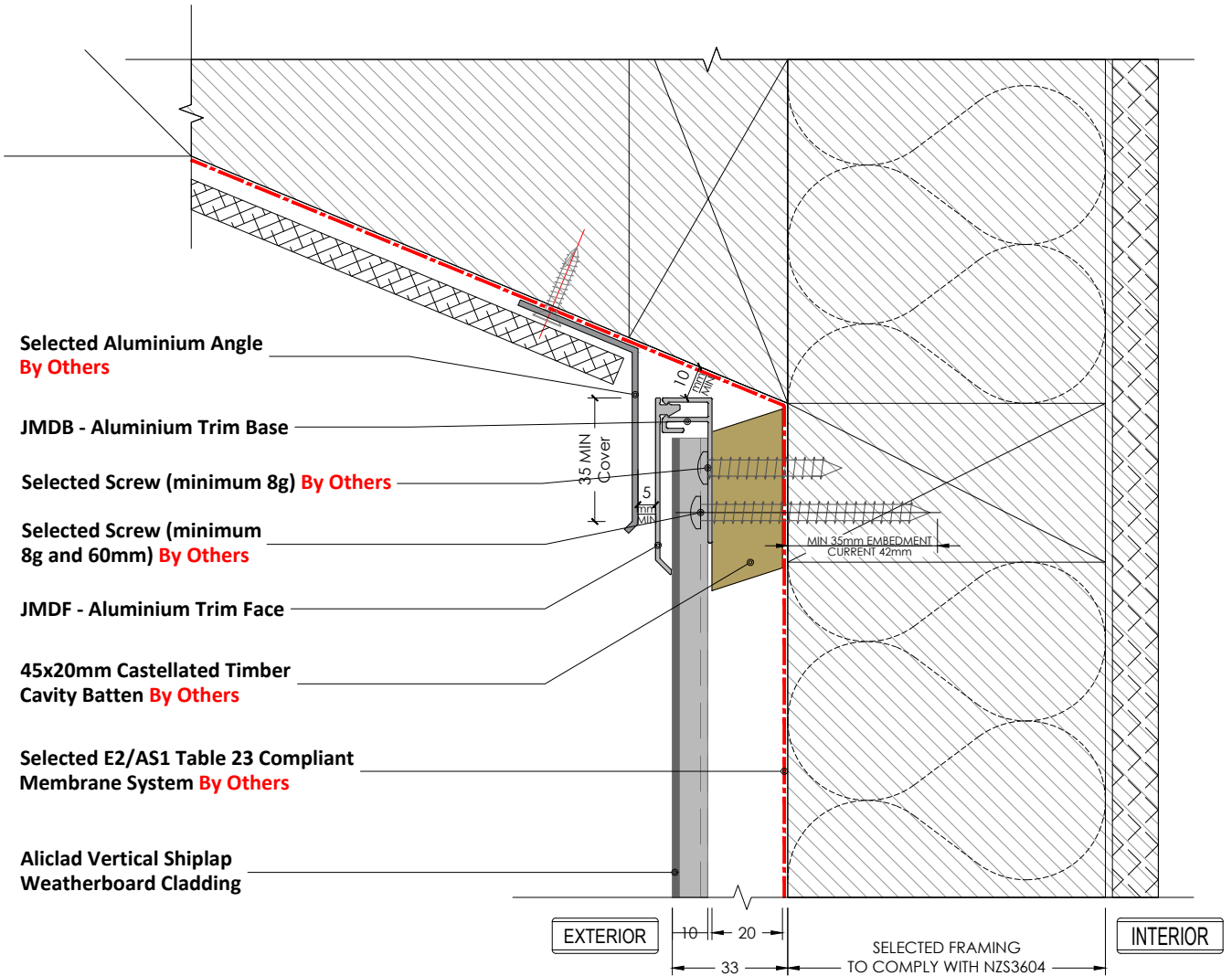

SOFFIT / EAVE TO WALL OP.2

Detail Number _____ 6.2

Scale _____ Version _____

A4 1:2 [2.0] - Aug 2024

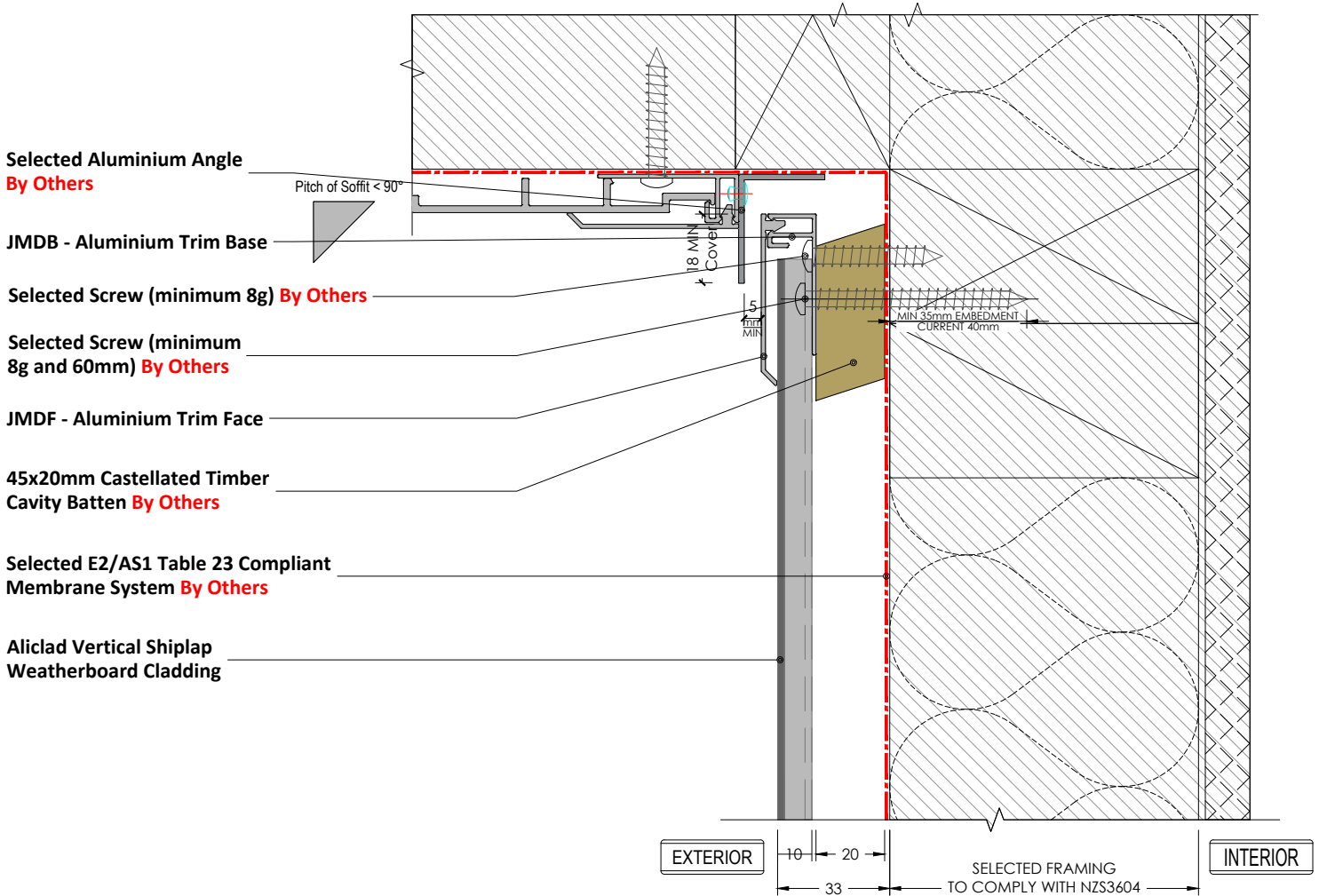

Refer to Test Report
SWTL R0067



SOFFIT / EAVE TO WALL OP.3

Detail Number _____
Scale _____ Version 6.3
A4 1:2 [2.0] - Aug 2024

Selected Flashing Tape Over Building
Wrap Jamb Return **By Others**

Selected E2/AS1 Table 23 Compliant
Membrane System **By Others**

45x20mm H3.1 Timber Cavity
Batten **By Others**

Selected Screw (minimum
8g) **By Others**

45x20mm Castellated Timber
Cavity Batten **By Others**

Danco 7412 Black EPDM Single Sided
Foam Tape 12mmx12mm

JMDB - Aluminium Jamb Base

JMDF - Aluminium Trim Face

Aliclad Vertical Shiplap
Weatherboard Cladding

Selected Sealant on PEF Rod to
suit gap **By Others**

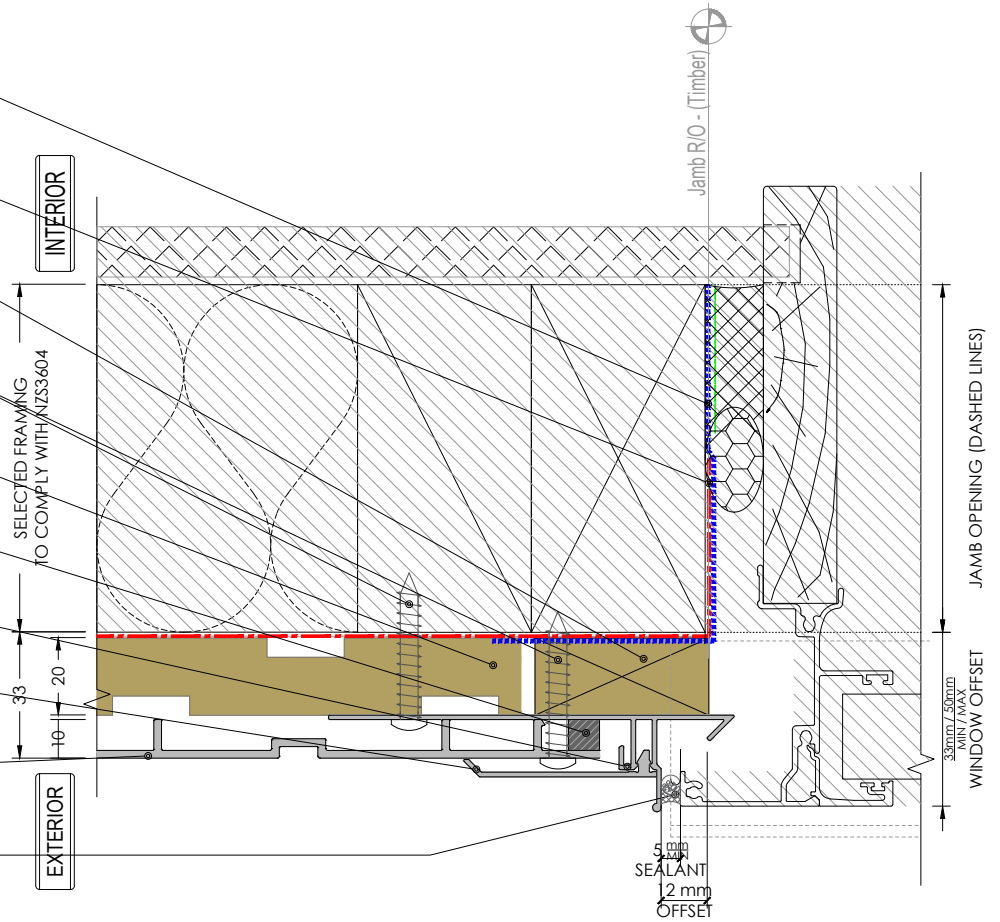

Refer to Test Report
SWTL R0067



TYPICAL WINDOW JAMB

Detail Number

7.0

Scale Version

A4 1:2 [2.0] - Aug 2024

Aliclad Vertical Siplap
Weatherboard Cladding

Selected E2/AS1 Table 23 Compliant
Membrane System **By Others**

Selected Flashing Tape Over Flashing
By Others

45x20mm Castellated Timber
Cavity Batten **By Others**

Selected Screw (minimum
8g) **By Others**

Selected Screw (minimum
8g and 60mm) **By Others**

JMDF - Aluminium Trim Face

Selected Cavity Closure **By Others**

BOC - Aluminium Bottom of Cladding Base

Selected Al. Head Flashing **By Others**

Selected Flashing Tape Over Building
Wrap Jamb Return **By Others**

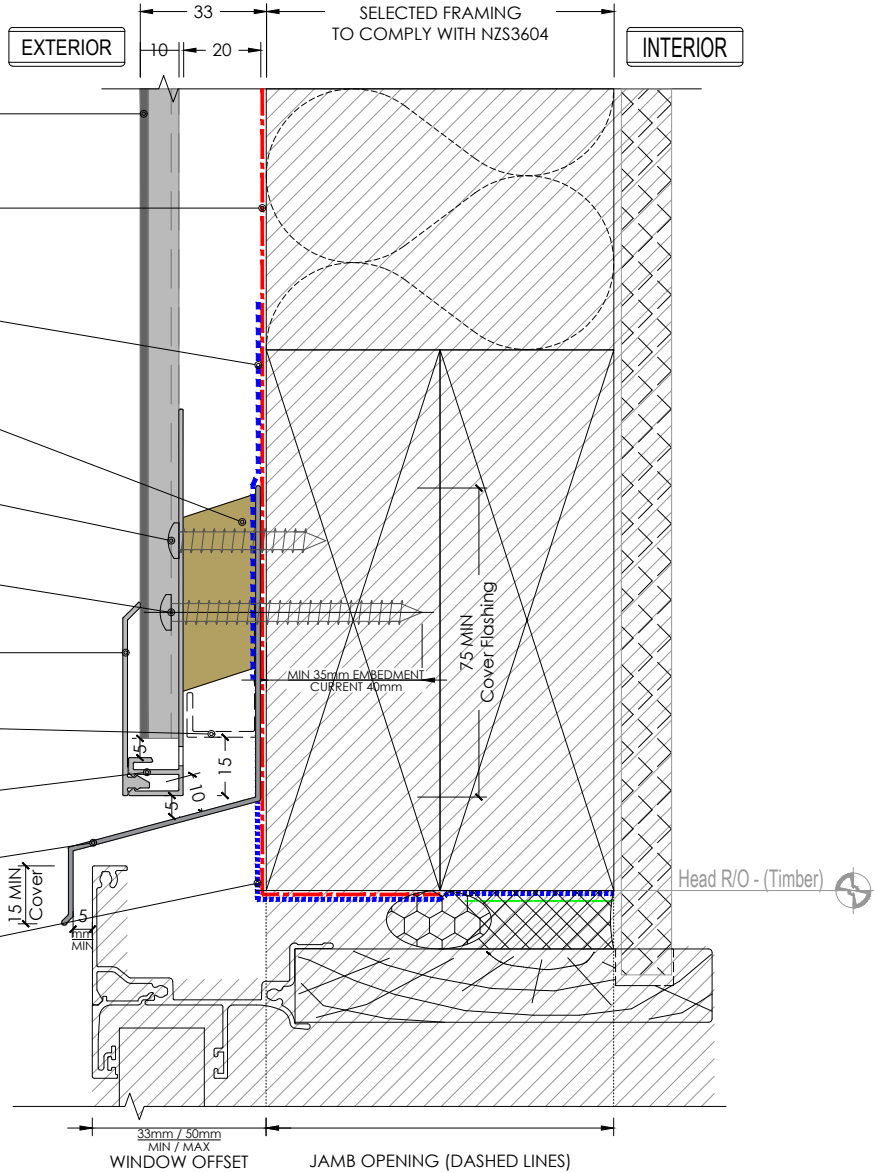

Alternative for E.H. Wind Zone

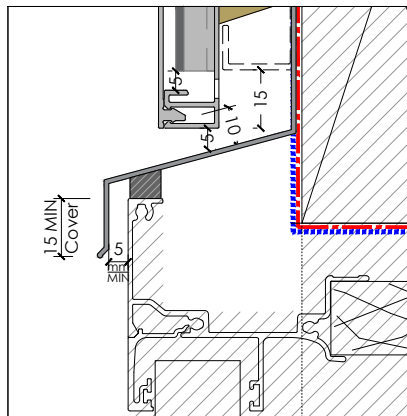

Refer to Test Report
SWTL R0067



TYPICAL WINDOW HEAD

Detail Number

7.1

Scale Version

A4 1:2 [2.0] - Aug 2024

**THE BUILDING
AGENCY**

MATERIALS • SYSTEMS • SOLUTIONS

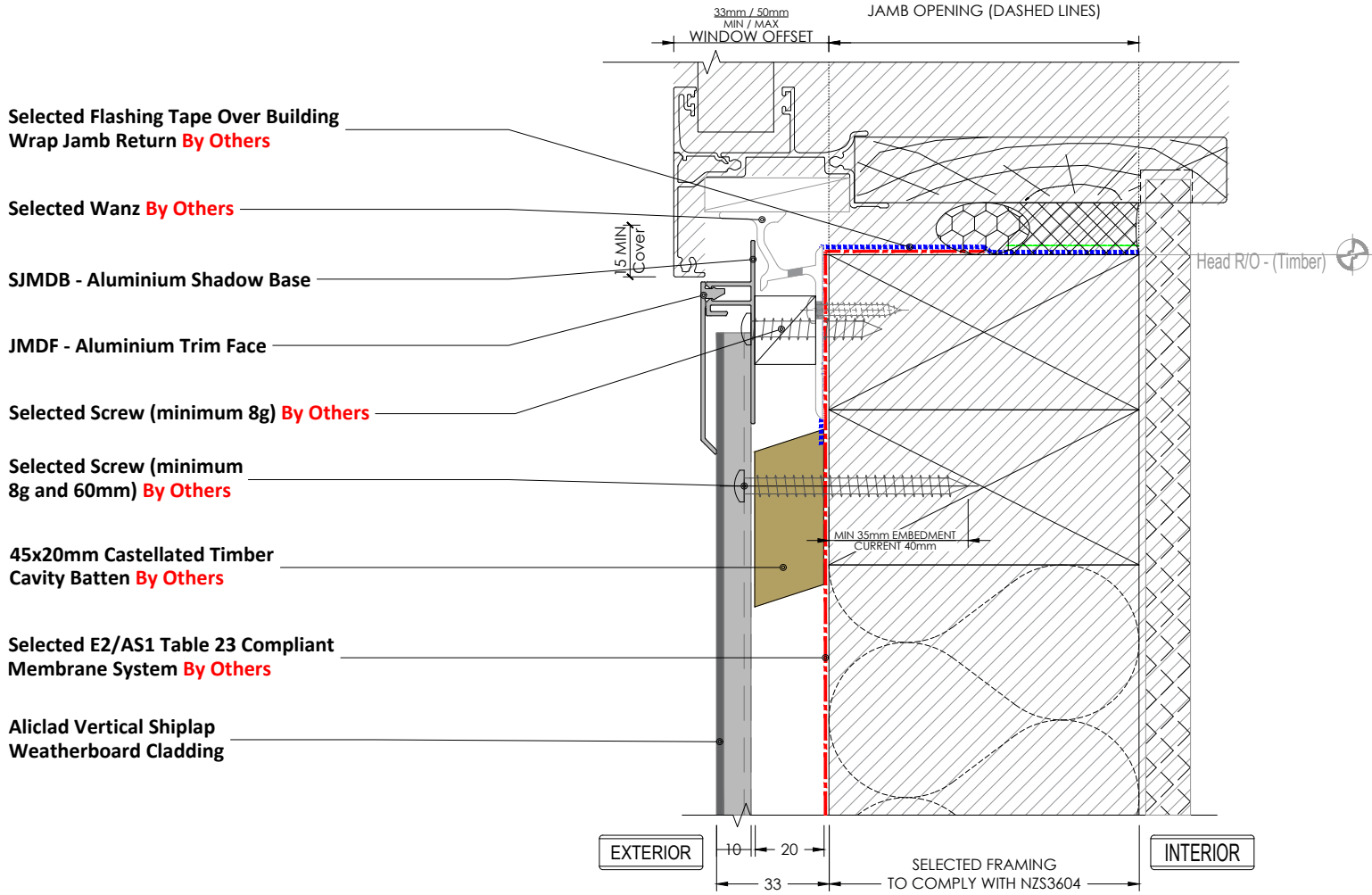

Refer to Test Report
SWTL R0067



TYPICAL WINDOW SILL

Detail Number _____
7.2

Scale _____ Version _____
A4 1:2 [2.0] - Aug 2024

Selected E2/AS1 Table 23 Compliant
Membrane System **By Others**

Selected Aluminium Parapet
Flashing **By Others**

Selected Screw (minimum 8g) **By Others**

Selected Packer to Suit Fix Point **By Others**

Selected Screw (minimum
8g and 60mm) **By Others**

45x20mm Castellated Timber
Cavity Batten **By Others**

Selected E2/AS1 Table 23 Compliant
Membrane System **By Others**

Aliclad Vertical Shiplap
Weatherboard Cladding

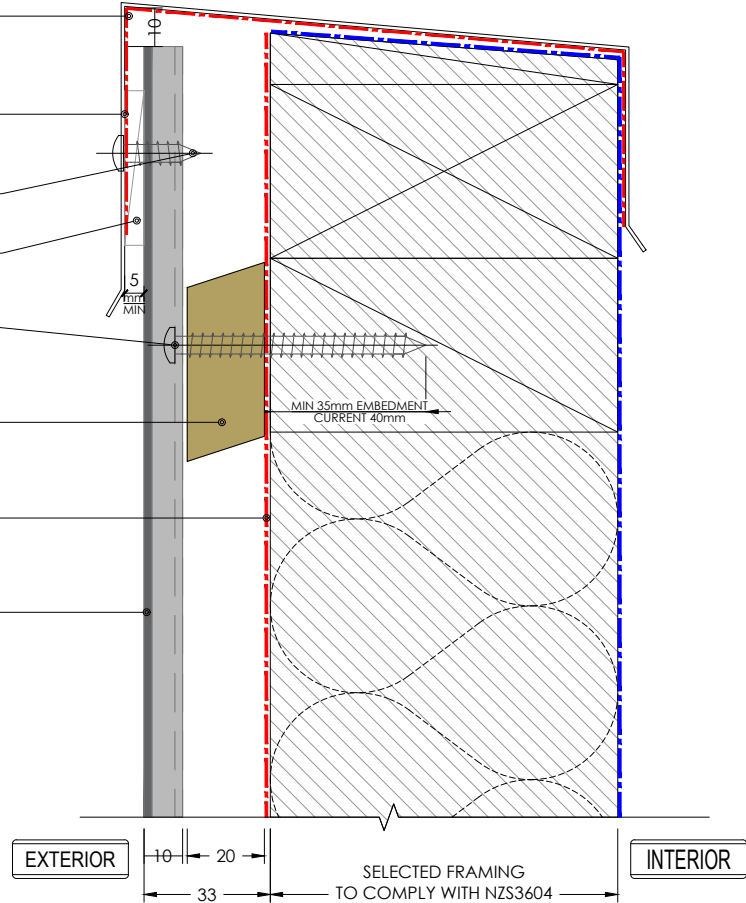

Refer to Test Report
SWTL R0067



TYPICAL PARAPET CAPPING

Detail Number
_____ 8.0
Scale _____
Version _____
A4 1:2 [1.0] - Aug 2024



MATERIALS • SYSTEMS • SOLUTIONS

Selected E2/AS1 Table 23 Compliant
Membrane System **By Others**

Selected Aluminium flashing
By Others

Selected Screw (minimum 8g) **By Others**

Selected Packer to Suit Fix Point **By Others**

Selected Screw (minimum
8g and 60mm) **By Others**

45x20mm Castellated Timber
Cavity Batten **By Others**

Selected E2/AS1 Table 23 Compliant
Membrane System **By Others**

Aliclad Vertical Shiplap
Weatherboard Cladding

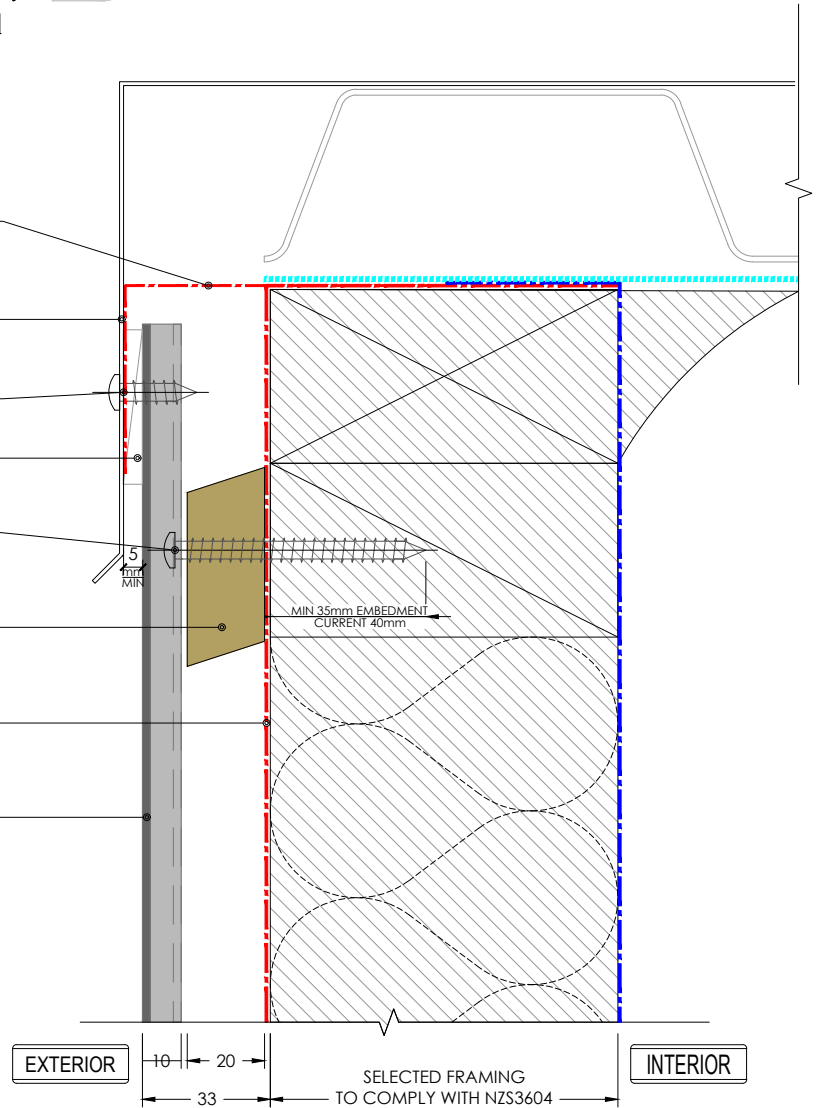

TYPICAL TOP OF CLADDING

Detail Number

8.1

Scale

Version

A4 1:2

[1.0] - Aug 2024

Aliclad Vertical Shiplap
Weatherboard Cladding

Selected Screw (minimum
8g and 60mm) **By Others**

45x20mm Castlatted Timber
Cavity Batten **By Others**

Selected Cover Flange
over Pipe **By Others**

Selected Pipe **By Others**

Selected Sealant to suit
gap **By Others**

Selected Trade Seal
By Others

Selected Sealant to suit
gap **By Others**

Selected E2/AS1 Table 23 Compliant
Membrane System **By Others**

Aliclad Vertical Shiplap
Weatherboard Cladding

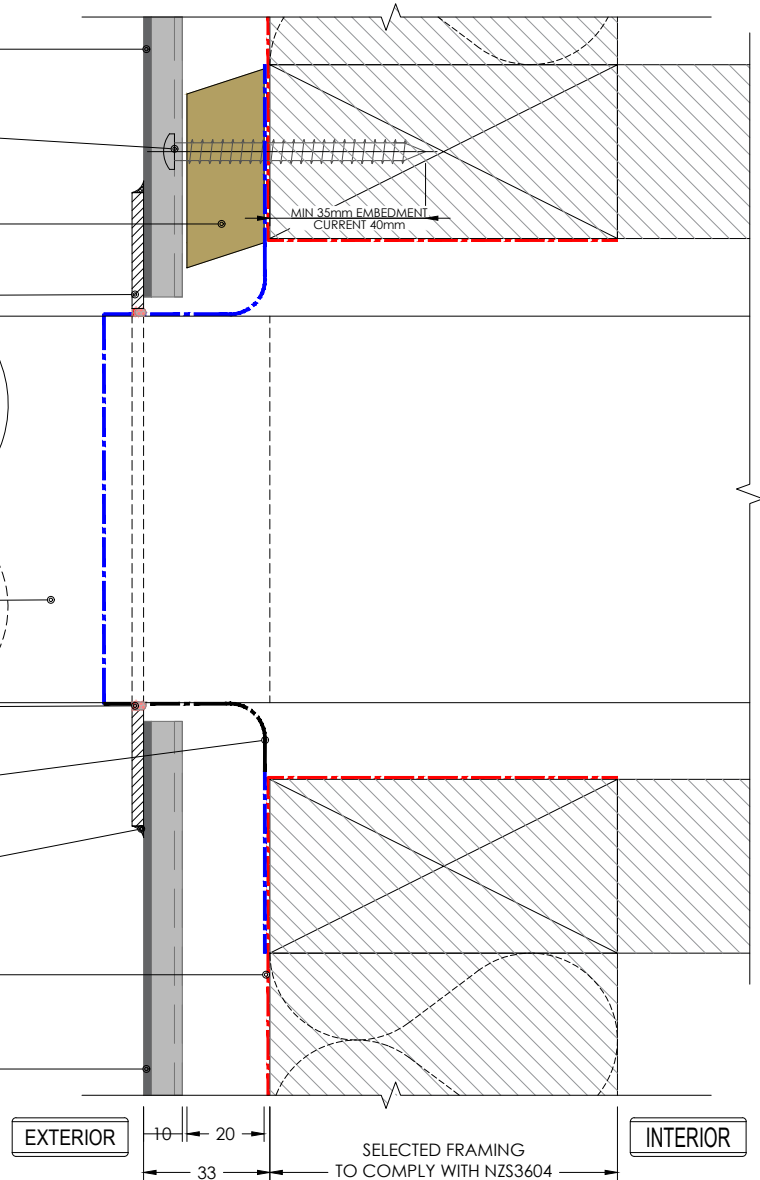

Refer to Test Report
SWTL R0067



TYPICAL PIPE PENETRATION

Detail Number

9.0

Scale Version

A4 1:2 [1.0] - Aug 2024

BA THE
BUILDING
AGENCY

MATERIALS • SYSTEMS • SOLUTIONS

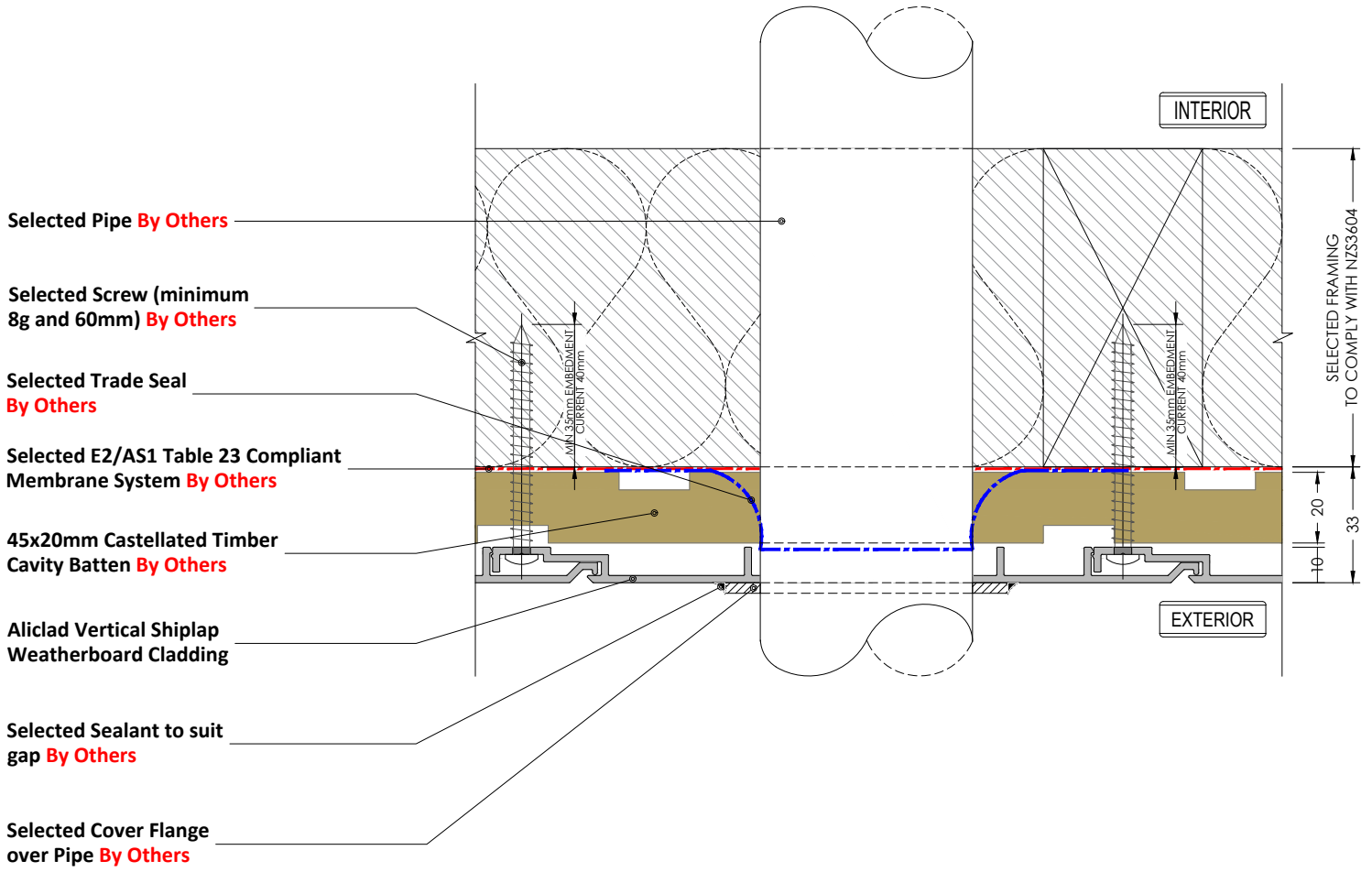

Refer to Test Report
SWTL R0067



TYPICAL SMALL PENETRATION

Detail Number _____ 9.2

Scale _____ Version _____

A4 1:2 [1.0] - Aug 2024

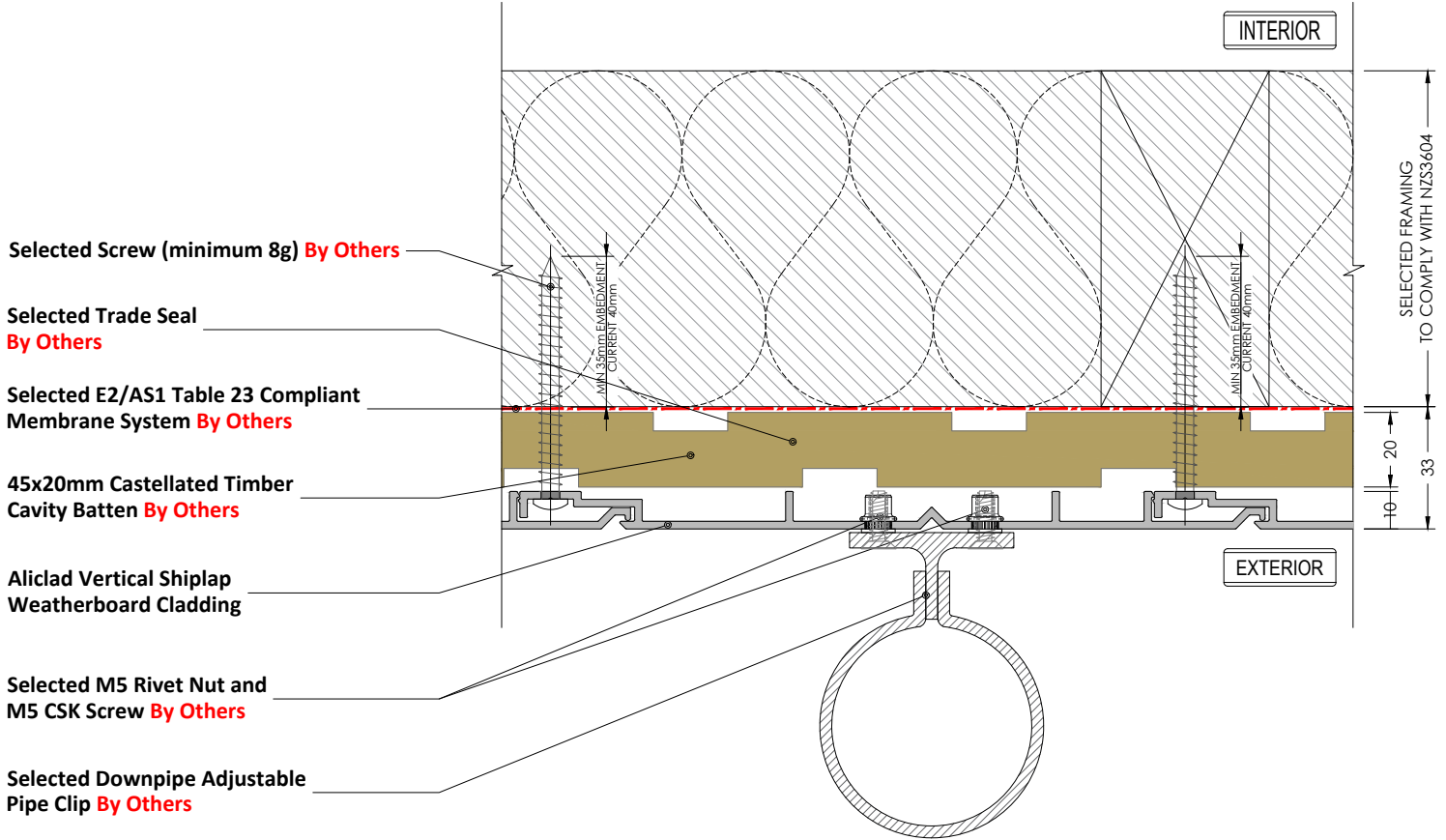

Refer to Test Report
SWTL R0067



TYPICAL DOWNPIPE CLIP DETAIL

Detail Number _____

Scale _____ Version 9.2

A4 1:2 [1.0] - Aug 2024